

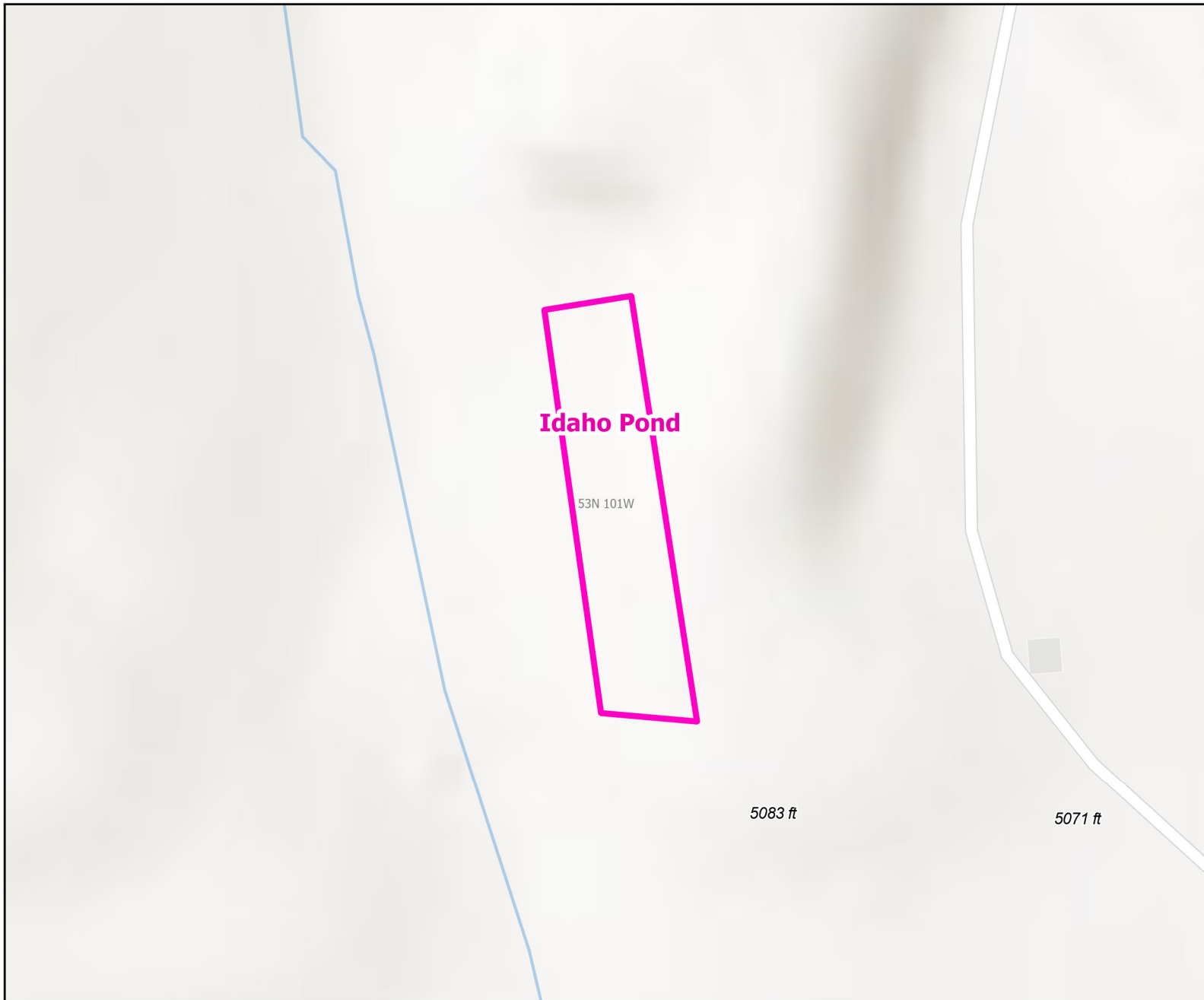

# Idaho Pond Public Access Area



Recreation Options: Fishing, Hunting  
 Access Dates: Open year round  
 Seasonal Closure:  
 Access Exceptions:  
 Area Regulations:  
 Shed Limitations:  
 Pheasant Release Dates:

This map is for visual use, assistance and general location only, does not represent a survey, and is not to be used for legal conveyance. Hunt Area boundaries are approximate, consult Game and Fish Hunting Regulations for descriptions and restrictions. Access to these private lands for any commercial activity must be gained by contacting the individual landowner(s) directly.